

60
YEARS
Of Excellence



ELEVATORS
BIRLA GROUP COMPANY



Antico

We Keep You Moving... Always

Truly Indian



www.eceelevators.com



If you have travelled in India, chances are you have travelled with us inside many prestigious buildings of this great nation. For over six decades now, ECE has been making state of the art elevators.

We are ECE...

"We keep you moving... Always!"

- Established in 1945, ECE is the only public listed company (National Stock Exchange) in the elevator industry.
- One of the leading domestic brand names in electrical equipment and elevators with 60 years of enriched experience.
- The first domestic player to engage in elevators manufacturing in India with long term successful technology collaboration with worldwide industry leaders of Europe and Japan.
- The one and only fully integrated manufacturing facility spread over 250,000 square feet in the National Capital Region at Ghaziabad, Uttar Pradesh.
- A dedicated and in house research and design team and amongst the very few of the elevator plants in India with capability to manufacture all lift components.
- Pan India field operations spread across 20 cities with thousands of elevators in service portfolio.
- More than 400 trained employees and growing with a product range positioned to address the entire spectrum of Indian market .
- ECE Elevator is made in India, is cost competitive and we strive to be India's most trustworthy elevator brand.
- ECE brings to the industry speed, agility, reliability and the human touch. We understand India better than most.
- ECE team is committed to its customers, the users and the environment.

Truly Indian

Value For Money

Comfort



ELEVATORS



Antico

THE ROBUST MACHINE

The robust ANTICO is a perfect partner to your taste and needs. Outstanding ease-of-maintenance, excellent comfort and reliable performance makes ANTICO India's all-time favorite machine. Your partner ANTICO is made in India exclusively keeping in view your special requirements.

Key Events

1945

Incorporation and commencement of operations for repairs and manufacture of electrical equipment's

1971

Set-up manufacturing facility for manufacturing elevators at Ghaziabad, Uttar Pradesh

2002

Transferred field operations of elevators division to ThyssenKrupp and entered into exclusive supply agreement with them (for 3 years) with non-compete for 5 years

2015

Expansion and modernization plans initiated in Elevator division with next generation in house products, best in class people and service systems

2017

Launch of 24X7 ECE call centre

Application Range

Passenger Capacity		4	5	6	8	10	13	15	16	20
Loads (Kgs)		272	340	408	544	680	884	1020	1088	1360
Speed (MPS)	0.5									
	0.7									
Entrance	Car : MTD, Landing : MTD									
	Car : MTD, Landing : SD									
	Car : CD / IMPD, Landing : CG / IMPD / SD									
	Car : CD / IMPD, Landing : CG / IMPD									
Travel Height		Max. 40 Meters								
Stops		Max. 12								
Control	Down Collective									
	Collective Selective									
Drive		Variable Voltage Variable Frequency								

Abbreviation : MTD - Manual Telescopic Door, SD - Swing Door, CD - Collapsible Gate, IMPD - Imperforated Door

Truly Indian

Value For Money

Comfort

WHY ? Antico



VALUE FOR MONEY

Antico is the best value for money for Indian needs and conditions. Antico's following unmatched characteristic makes it a value for money deal for you:

- Lowest acquisition cost
- Amazingly low cost of ownership
- Optimized and customized shaft dimensions

The robust technology of Antico ensures hassle free ride.



COMFORT

Antico is serving you since decades, which itself is the biggest testimonial of its reliability.

60 years of experience provides an ability to offer a new and fresh look ANTICO with added comfort achieved through:

- Improved ride quality
- ACVWF drive as standard
- Refreshing cab finishes



SAFETY

ANTICO provides adequate safety to passengers. It is loaded with following safety features, which ensures passenger safety:

- Over speed governor
- Emergency light
- Emergency alarm

A Six decade long safe work culture of ECE combined with domain expertise ensures

Safely

We keep you moving..^..always.



STANDARD CAR ANSC-001

Finish	Panels	Mild steel powder coated - RAL 1014
	Corner Panel	Mild steel powder coated - Golden Yellow
False Ceiling	Type	Mild steel powder coated - ANFC-001 SSHL : ANFC-001SS (option)
	Color	RAL 1014
Flooring	Type	Vinyl Tiles
	Color	Super Cream
Car Height	Below false ceiling	2100 mm



CAR OPERATING PANEL ANCOP-7-R

Position	Inside car on side panel
Face Plate	
Type	Flat
Finish	Stainless Steel
Indicator	7 Segment
Button	
Type	Illuminated micro push button
Button Head	Stainless Steel Hair line with Braille
Illumination	
Type	LED
Color	Red

LANDING OPERATING PANEL ANLOP-7-R / ANLOP-7-O

Position	On each landing
Face Plate	
Type	Wall Mounted
Finish	Stainless Steel Hairline
Indicator	7 Segment
Button	
Type	Illuminated micro push button
Button Head	Stainless Steel Hair line with Braille
Illumination	
Type	LED
Color	Red / Orange (option)



Truly Indian

Value For Money

Comfort



ELEVATORS



**CAR OPERATING PANEL
ANCOP-7-0**

Position	Inside car on side panel
Face Plate	
Type	Flat
Finish	Coated sheet
Indicator	7 Segment
Button	
Type	Illuminated micro push button
Button Head	Stainless Steel Hair line with Braille
Illumination	
Type	LED
Color	Orange



FALSE CEILING : ANFC-101 / ANFC-101PC

Finish	Stainless steel hairline finish / MSPC
Illumination	LED Spotlight
Fan	Pressure fan with grill



HANDRAIL : ANHR-001

Material	Stainless steel hairline finish
Shape	Round



Imperforated Door



Steel Swing Door



Telescopic Door



Collapsible Gate

PVC FLOORING



Ocean Blue



Lilly White



Light Grey



Super Cream

METAL EFFECTS



Stainless steel honey comb



Stainless steel hairline

POWDER COATING COMBINATIONS



Nickel Grey / Purple



Ivory / Orange



RAL1014 / Golden



Sand Beige / Purple



Ivory / Blue



Dark Grey / Pista Green



Sand Beige / Orange



Pista Green / Golden



Sand Beige / Brown Leatherite



RAL1014 / Signal Red

LAYOUT

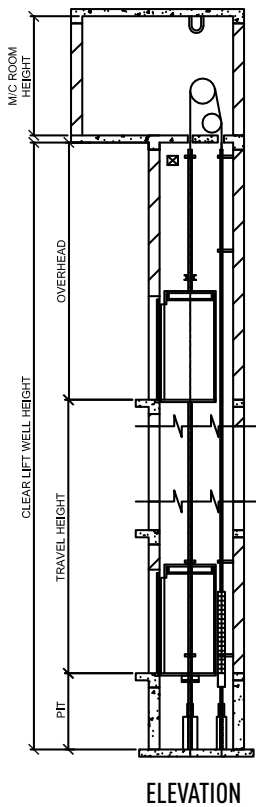

MANUAL COLLAPSIBLE GATE / IMPERFORATED GATE

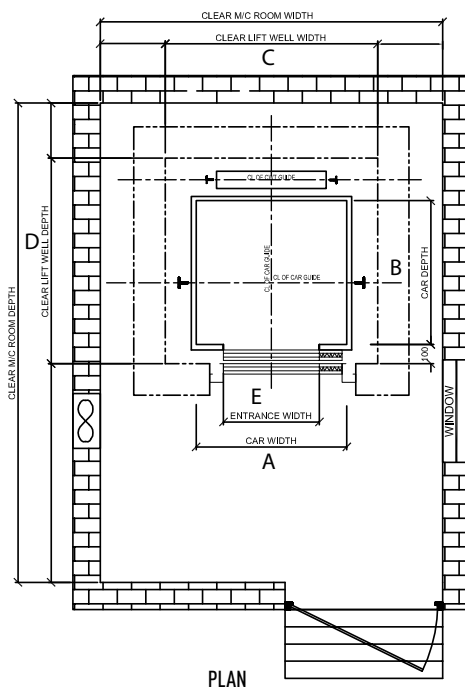

Door Handage :
1. Right Hand As Shown
2. Left Hand Opposite

MANUAL TELESCOPIC DOOR

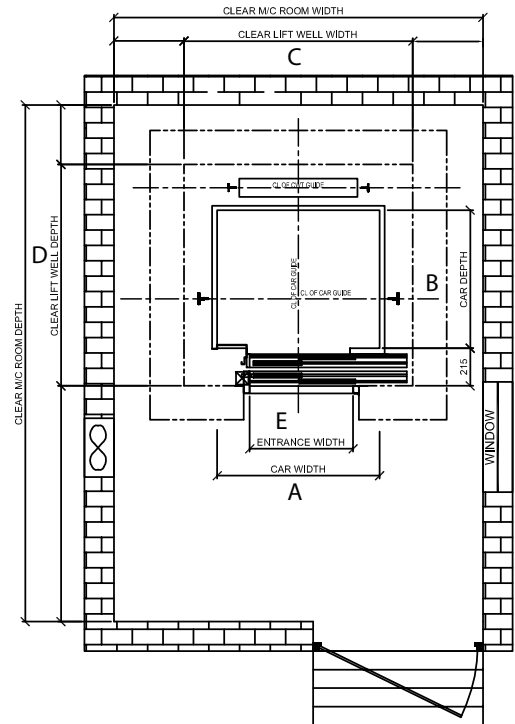

Door Handage :
1. Right Hand As Shown
2. Left Hand Opposite

MANUAL COLLAPSIBLE GATE WITH SWING DOOR

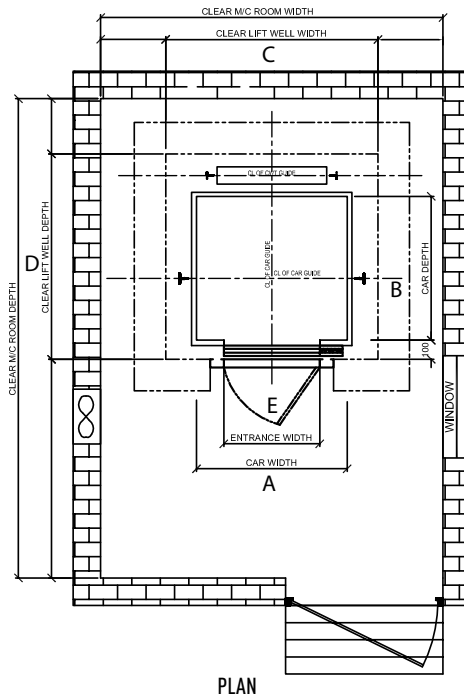

Door Handage :
1. Right Hand As Shown
2. Left Hand Opposite

MANUAL TELESCOPIC WITH SWING DOOR

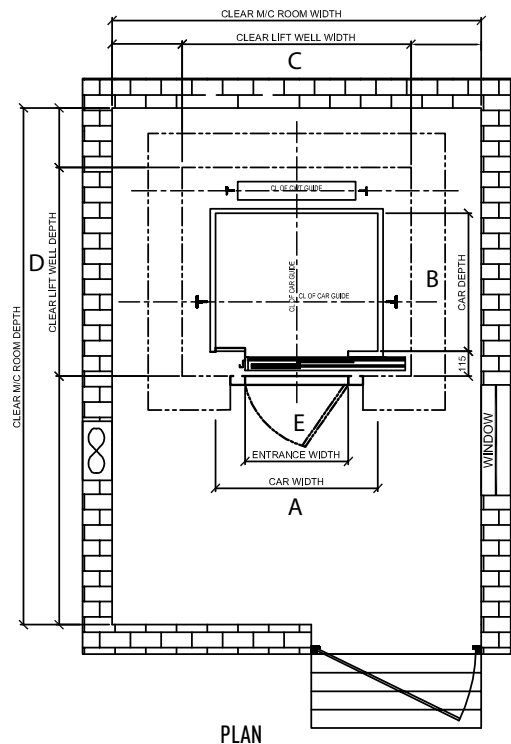

Door Handage :
1. Right Hand As Shown
2. Left Hand Opposite

DIMENSIONS



ELEVATORS

Rated Load (Kgs)	Nominal Speed (mps)	Car Size A x B mm	Min. Hoistway Size C x D mm	Door Size E x HIGH mm	Entrance Rough Wall Width x HIGH	Car Door Type	Landing Door Type	Pit Depth mm	Overhead mm
272Kgs (4P)	0.7	1100 x 700	1500 x 1250	700 x 2000	970 x 2150	Manual Telescopic	Manual Telescopic	1350	4250
340 Kgs (5P)		900 x 850	1350 x 1400						
	1100 x 850	1500 x 1400							
408 Kgs (6P)	0.7	900 x 1000	1350 x 1550						
		1100 x 1000	1500 x 1550						
		1200 x 900	1600 x 1450						
544 Kgs (8P)	0.7	900 x 1200	1350 x 1750	800 x 2000	1070 x 2150				
		1000 x 1100	1400 x 1650						
680 Kgs (10P)	0.7	1300 x 1100	1700 x 1650						
		1200 x 1200	1600 x 1750						
680 Kgs (10P)	0.7	1350 x 1300	1750 x 1850						
		1300 x 1350	1700 x 1900						

272Kgs (4P)	0.7	1100 x 700	1500 x 1150	700 x 2000	970 x 2150	Manual Telescopic	Swing Door	1350	4250
340 Kgs (5P)		900 x 850	1350 x 1300						
	1100 x 850	1500 x 1300							
408 Kgs (6P)	0.7	900 x 1000	1350 x 1450						
		1100 x 1000	1500 x 1450						
		1200 x 900	1600 x 1350						
544 Kgs (8P)	0.7	900 x 1200	1350 x 1650	800 x 2000	1070 x 2150				
		1000 x 1100	1400 x 1550						
680 Kgs (10P)	0.7	1300 x 1100	1700 x 1550						
		1200 x 1200	1600 x 1650						
680 Kgs (10P)	0.7	1350 x 1300	1750 x 1750						
		1300 x 1350	1700 x 1800						

Rated Load (Kgs)	Nominal Speed (mps)	Car Size A x B mm	Min. Hoistway Size C x D mm	Door Size E x HIGH mm	Entrance Rough Wall Width x HIGH	Car Door Type	Landing Door Type	Pit Depth mm	Overhead mm
272 (4P)	0.7	1100 x 700	1500 x 1100	700 x 2000	1000 x 2250	CG / IMP	CG / IMP / SWING	1350	4250
340 (5P)		900 x 850	1300 x 1250						
	1100 x 850	1500 x 1250							
408 (6P)	0.7	900 x 1000	1300 x 1400						
		1100 x 1000	1500 x 1400						
		1200 x 900	1600 x 1300						
544 (8P)	0.7	900 x 1200	1300 x 1600	800 x 2000	1100 x 2250				
		1000 x 1100	1400 x 1500						
680 (10P)	0.7	1300 x 1100	1700 x 1500			CG / IMP			
		1200 x 1200	1600 x 1600						
680 (10P)	0.7	1350 x 1300	1750 x 1700						
		1300 x 1350	1700 x 1750						
884 (13P)	0.7	2000 x 1100	2400 x 1550	900 x 2000	1200 x 2250				
		1100 x 2000	1700 x 2300						
		1700 x 1250	2100 x 1700						
		1250 x 1700	1650 x 2150						
1020 (15P)	0.7	2000 x 1200	2400 x 1650	1000 x 2000	1300 x 2250		CG / IMP		
		1200 x 2000	1800 x 2300						
		1000 x 2400	1600 x 2700						
1088 (16 P)	0.7	1600 x 1600	2000 x 2050						
1360 (20 P)	0.7	2000 x 1300	2400 x 1750						
1360 (20 P)	0.7	2000 x 1500	2400 x 1950						

General Note

- All dimensions are in millimeters. All dimensions are clear finished lift wells after plastering. Dimensions are suitable for lifts speed upto 1 m/s.
- 2400mm minimum opening height required at lowest and ground floor levels for entry of assembled equipment in shaft.
- Dimensions in the machine room depend on number and orientation of lift shafts. Lifting hook is required in machine room slab . All walls minimum 150mm (RCC) or 230mm (brick).
- Hoistway vertically (Plumness) will be with in +50mm. For specific requirements our local representative will be happy to work with you in preparation of the drawings.
- RCC machine room structural slab minimum 150 mm thick, designed to sustain minimum 1000 kg/m² UDL. Plus reaction loads shown in GAD for specific requirements our local representative will be happy to work with you in preparation of the drawings
- Hoistway front wall 230mm brick preferred. Door below lintel height to be minimum = Entrance height + 250mm.
- At every floor level on side & rear wall RCC floor beam will be provided
- For 15, 16, and 20 passengers please contact sales representative

Truly Indian

Value For Money

Comfort



ELEVATORS
AN ISO 9001:2008
CERTIFIED COMPANY

NETWORK

- REGISTERED OFFICE
- PLANT
- BRANCH OFFICE
- RESIDENT ENGINEERS



NORTH

DELHI
NEW DELHI
ECE House Annexe,
28A, K.G. Marg, New Delhi - 110 001
Tel : 011-23314237 / 38 / 39

UTTAR PRADESH
NOIDA
G - 39, Sector - 63, Noida
Dist . Gautam Budh Nagar - 201 301
Tel : 0120 - 4545200

LUCKNOW
B-103, Sector-C, Mahanagar,
Dist . Lucknow - 226 006
Tel : +91 - 770 408 0111

PUNJAB
MOHALI
SCO No. - 12-13, 2nd Floor, Sector - 65 A,
Phase-XI, Mohali - 160 055
Tel : +91 - 814 616 8095

RAJASTHAN
JAIPUR
211, Vidyut Nagar, Vaishali Nagar
Jaipur - 302021
Tel : +91 - 810 746 6676

Resident Engineer
» Ludhiana » Amritsar
» Jodhpur » Kota
» Dehradun » Kanpur

SOUTH

KARNATAKA
BENGALURU
Unit No. 112 & 113, Ground Floor,
Level 1, Prestige Centerpoint,
Cunningham Road, Bengaluru - 560 052
Tel : 080 - 22220587 / 2224570

MYSURU
32, 9th Main, 5th Block, Jayalakshmiapuram,
Mysuru - 570 012. Tel : 0821-424 4409

HUBLI
Tapas Mansion, Near Jain Mandir,
2nd Cross, Hosur, Hubli - 580 021
Tel : +91-789 957 2700

TAMIL NADU
CHENNAI
New No - 17, Old No. 9, Wood Road,
1st Floor, Chennai - 600 002
Tel : 044-286 051 55
TELANGANA
HYDERABAD
Ashok Marg, Sanathnagar,
Hyderabad - 500 018. Tel : 040 - 238 144 33

ANDHRA PRADESH
VIZAG
49-42-2/2, N.G.G.O's Colony
Akkayyapalem, Vizag - 530 016
Tel : +91 - 996 605 1793

Resident Engineer
» Mangaluru » Vijaywada

WEST

MAHARASHTRA
MUMBAI
Shop No. 20, Ground Floor,
Mermaid Sea View-CHS Limited, Sector 11,
CBD Belapur,
Mumbai - 400 614
Tel : +91 823 755 7300

PUNE
Plot No. L-9, CTS No. 14/4+14/5,
Narale Sadan, Erandwane CHS Ltd,
Opposite Dimanath Mangeshkar Hospital,
Erandwane, Pune 411 004

GUJARAT
VADODARA
102, Bonny Apartment,
Behind Baroda Gas Project, AlkaPuri,
Vadodara - 390 005
Tel : 0264 - 233 691

VALSAD
Khushbu Mahal Apartment,
Ground Floor, G-7, Nr. ST. Stand,
Valsad - 396 001
Tel : +91 - 990 440 2096

Resident Engineer
» Ahmedabad
» Surat

EAST

WEST BENGAL
KOLKATA
P-46A, CIT Scheme XLV, Radha Bazar Lane,
Kolkata - 700 001
Tel : 033 - 222 54686

ASSAM
GUWAHATI
53, Madhabdevpur,
Rehabari, Guwahati - 781008
Tel : 0361 - 246 4813

JHARKHAND
RANCHI
H-62, Agora Housing Colony,
Argora, Ranchi - 834 002
Tel : +91-930 802 0702

ODISHA
BHUBNESHWAR
Plot No. N-1/224, IRC Village,
P.S-Nayapali, Bhubneshwar - 751 015
Tel : 0674 - 2555684

Resident Engineer
» Siliguri
» Dhanbad
» Jamshedpur
» Raiganj

CENTRAL

MAHARASHTRA
NAGPUR
U-06, Parvati Complex,
Ring Road, Padoley Layout,
Swawlambi Nagar, Nagpur - 440 022
Tel : +91-9146017300

CHATTISGARH
RAIPUR
C-06, Sector-03, Devendra Nagar,
Raipur - 492 001
Tel : +91-911 102 2214

MADHYA PRADESH
INDORE
EC-40, Scheme No. 94,
Opposite Hotel Raddison,
Ring Road, Indore - 452010
Tel : 0731-2558220

REGISTERED OFFICE
28/A, Kasturba Gandhi Marg,
New Delhi - 110001.
Tel : 011-23314237, 011-23314238,
011-23314239, 011-32944708
Fax No : 011-23310410.

PLANT
A - 20, Industrial Area, Meerut Road,
Ghaziabad - 201001.
Tel : 0120-2712065, 0120-2712037,
0120-2713843
Fax No : 0120-2723950

tollfree
24/7 customer care
1800 5 323 323
1800 5 ECE ECE

email
sales@ecelelevators.com



web
www.ecelelevators.com

